

Fiat Ducato III / Serie 8
Soundpackage 1 and 2

Installation instructions

Status: 19.03.2024

Art. No. 69071-80-86, 69071-80-62-Q / 69081-62-Q,
 69071-86-Q / 69081-86-Q, 69081-62-Miko / 69081-86-Miko
 69072-80-86, 69072-80-62-Q / 69072-86-Q 69082-62-Q,
 69082-86-Q / 69082-62-Miko / 69082-86-Miko



3-way cab system Fiat Ducato III (Type 250) and Series 8

(69071-80-86, 69071-80-62-Q / 69071-86-Q 69081-62-Q, 69081-86-Q / 69081-62-Miko / 69081-86-Miko)

(69072-80-86, 69072-80-62-Q / 69072-86-Q 69082-62-Q, 69082-86-Q / 69082-62-Miko / 69082-86-Miko)

Model/year: Fiat Ducato III (Type 250) My. 2006-2021

Series 8 from Bj. 2021



Packing list:

- 2x 26mm neodymium softdome tweeter „XE26“.
- 2x 80 mm midrange driver „XE80
- 2x 165 mm JEHNERT Power Woofer „XM165“ mounted to adapter ring
- 2x MHT crossovers wrapped in damping fleece
- 1x digital 5-channel amplifier incl. 2,2m Iso cable (standard or high power)
- 1x door subwoofer (standard (2x13er Subwoofer incl. connection cable) or High Power (1x 20er subwoofer incl. 3,3m plug & play cable) or Miko subwoofer 1x 165mm woofer incl. 1m subwoofer cable)
- Mounting set MHT module:
- 10x sheet metal screw 3.9 x 32 (with collar)



for sound package 2 :

2x living room boxes of your choice incl. installation set and installation instructions



Mounting kit (standard door subwoofer):

- 4x rubber grommet
- 2x round plug
- 2x round plug sleeve
- 1x 3.9 collar screw
- 1x washer

Mounting kit (High Power door subwoofer):

- 4x rubber grommet
- 1x felt cutout large (cover cupholder cutout)

Mounting set (Miko subwoofer):

- 2x Spax screw 4x50
- 2x washer 4.2 x12

Required tools / accessories

- Phillips screwdriver
- Torx screwdriver TX25
- Cutter knife (sharp!)
- white marker
- hot glue gun
- hot air gun
- plastic wedge
- padding material as surface protection
- Insulating tape

Mittelhochton-Weiche

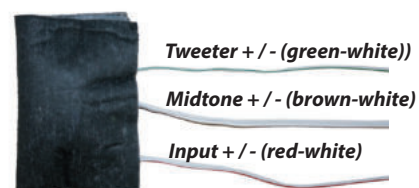

1a. Mounting the mid-high module on the dashboard (III and Serie 8)



1a.1. JEHNERT midrange driver
Remove from the module.



1b.2. JEHNERT mid-range module without loudspeakers on the dashboard. Align the dashboard: Place the curvature of the module against the curvature of the dashboard and ensure that there is an even distance between them.



1a.3 Mark the speaker cutout on the dashboard (white marker).



1a.4. heat the marked cutout well with a hot-air dryer and cut out with a sharp cutter knife.



1a.5 Loosen the rubber door seal in the A-pillar area.



1a.6 Carefully lever out the A-pillars with the plastic wedge and remove them from the vehicle in twos.

1a Mounting the mid-high module on the dashboard (III and Serie 8)

1a.7. assembly of the crossover

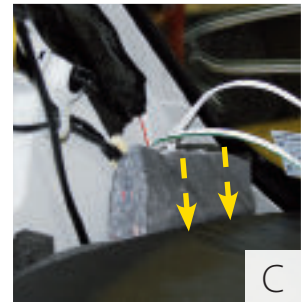
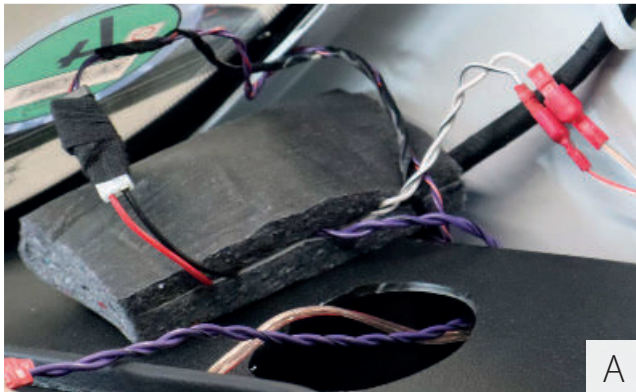

- Connect crossover with connection cable with original plug.
- Insert crossover together with damping material into the A-pillar (see fig. A+C) and pull the connection cable for the tweeter and midrange driver through the hole. (fig. B) --> tweeter connection marked/red = +
- Mount A-pillar again

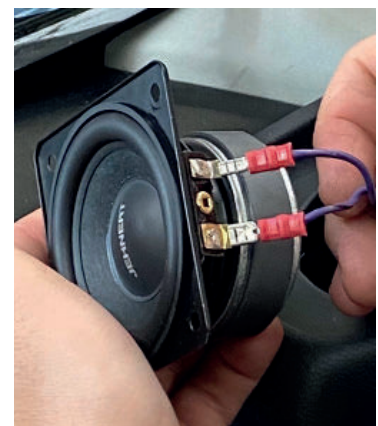

- Screw the molded part to the dashboard for a precise fit.
- Connect the midrange speaker to the cable connection of the crossover and mount it to the molded part.



Carefully press the acoustic fabric trim onto the
onto the molded part.

2a Woofer mounting in the vehicle door (III)



2a.1. lever out the loudspeaker cover in the vehicle door from below starting from the bottom (with plastic wedge).



2a.2 Dismantle the factory loudspeaker and disconnect the connection cable. The factory screws are used for fastening the JEHNERT low-frequency adapter.



2a.3. run factory speaker cable between door panel and plastic trim behind the woofer opening (see fig. marked area).



2a.4. mount the woofer adapter with the factory screws.
Connect and mount JEHNERT woofer.
Put on the loudspeaker cover.

2b. Mounting the woofers (Ducato series 8) (at original woofer mounting position)

2b.1. removal of the door panel

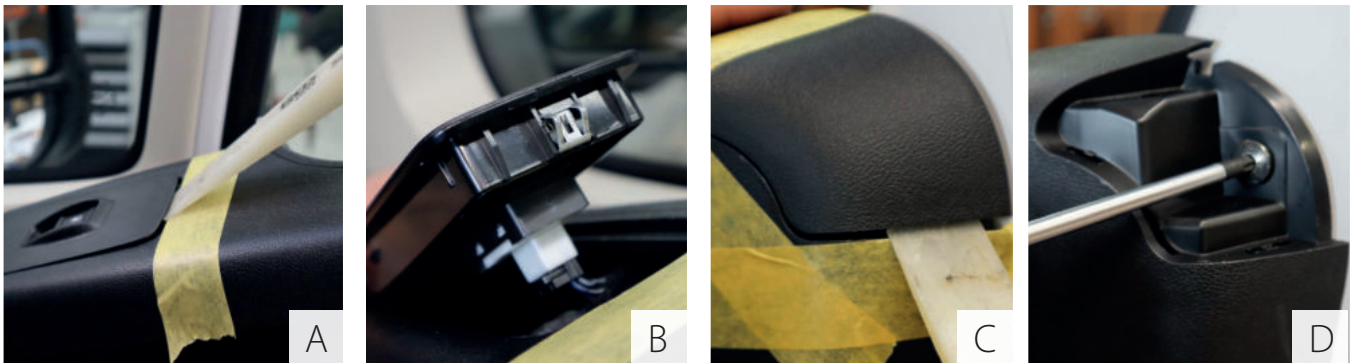

• Use a plastic wedge to carefully remove the door panel cover so that no scratches occur, secure the edges with adhesive tape. (Fig. A-C)

• Use a slotted screwdriver to remove the screws and covers of the door trim (Fig. D-J)

! remove all screws 8 x TX30 1x TX20 (Fig. E)

C: Finally, remove the two screws from the door handle and carefully remove the door trim. (Fig. G)

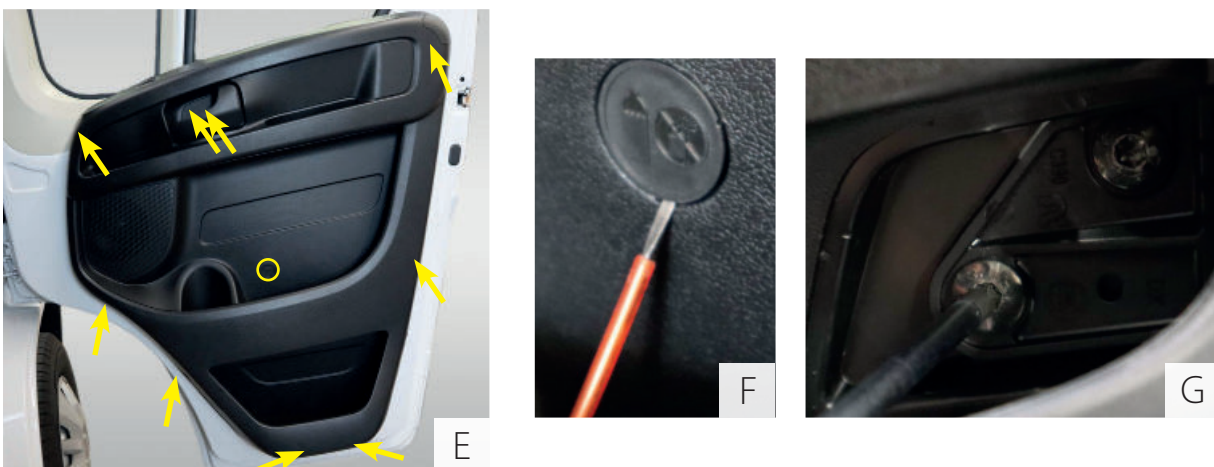

• Unclip door

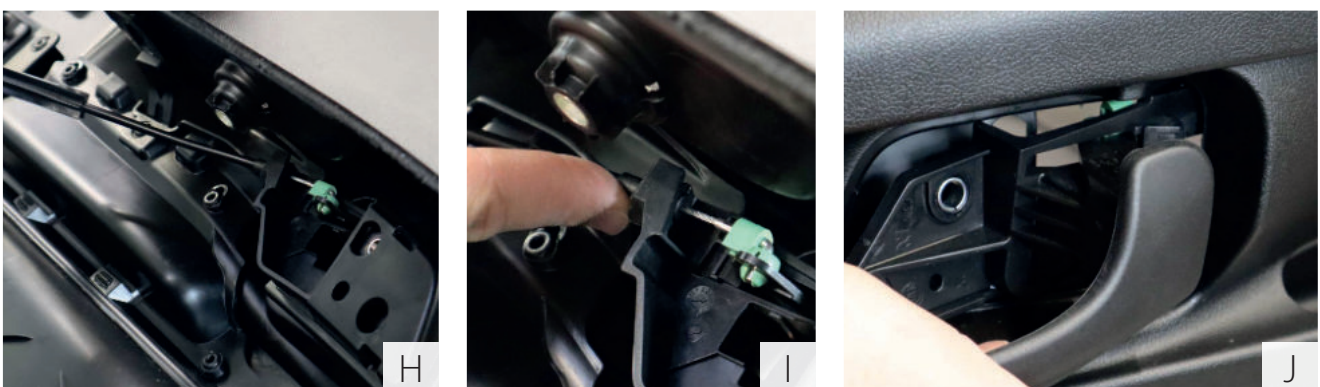

D: Use your finger to pry out the door handle connection and remove the door handle. (Fig. I)

F: Now the woofer can be installed.

2b. Mounting the woofers (at original woofer mounting position)

2b.2. woofer mounting in the car door



- Disassemble all screws of the factory woofer (pick up screws) 3x TX20



- Using a TX20 screwdriver, install the three screws from the woofer ring to the vehicle door.
- Connect the cables together.
- Refit the door trim. (Attach screws)

3. amplifier mounting

Please note:

Power cable and plug are not included in the scope of delivery!

3.1 Disassembly of the glove box and footwell cover



3.2 If not already done: Remove the glove compartment on the passenger side: Unscrew screws 1 - 5 (see Fig. A).

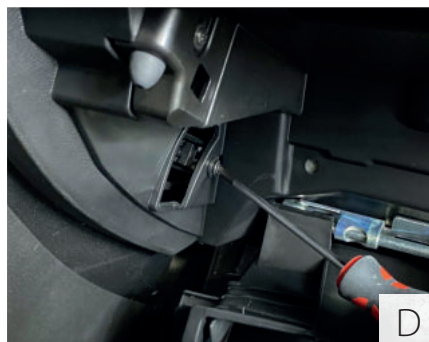

- Use the plastic wedge to detach the glove compartment from the suspension (see fig. C).
- Remove the screw behind it and take out the glove box (fig. D and E).

3.2 Positioning and installation of the amplifier

Mounting location: next to glove box under the dashboard

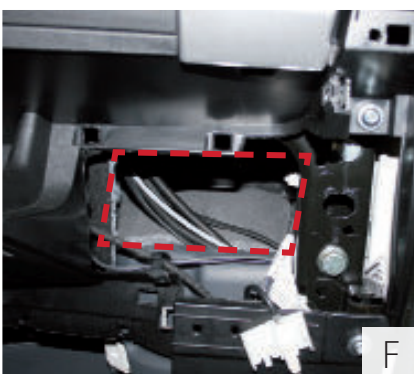

- Cut out yellow marked area with a cutter knife, simplifies the mounting of the amplifier

**Fiat Ducato III / Serie 8
Soundpackage 1 and 2**

Installation instructions

Status: 19.03.2024

Art. No. 69071-80-86, 69071-80-62-Q / 69081-62-Q,
69071-86-Q / 69081-86-Q, 69081-62-Miko / 69081-86-Miko
69072-80-86, 69072-80-62-Q / 69072-86-Q 69082-62-Q,
69082-86-Q / 69082-62-Miko / 69082-86-Miko

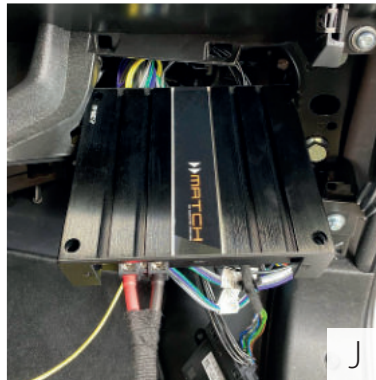

- Line the inside of the marked opening with 4x 20x20cm insulation fleece (see fig. I).
- Insert the amplifier into the opening lined with insulating fleece and ensure that it is firmly seated (see fig. J and K).



Important: Do not wrap the amplifier with insulating material, as it must radiate low heat!

Connect amplifier - see connection diagram on following page

Important: Only after all cables have been connected connect the amplifier to the vehicle battery.



Ground point amplifier

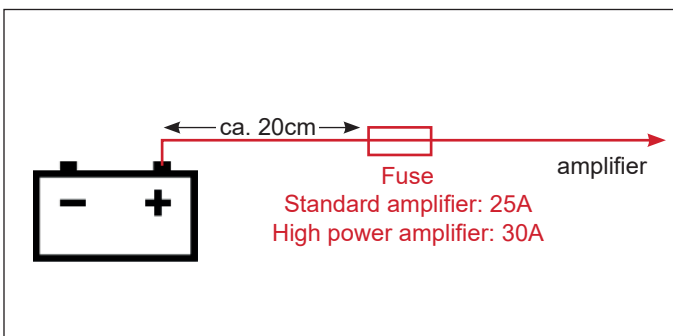

Route the power cable from the vehicle battery to the amplifier installation location and protect it with a fuse.
(Power line and fuse not included).

Important:
for standard amplifiers: power cable 2.5mm² +/-
for high power amplifiers: power cable 10mm² +/-

amplifier	⊕ = +12V
amplifier	⊖ = GND

Connect ground wire (not included) from amplifier to ground point.

Or:
Lead the ground line from the amplifier to the vehicle battery. ⊖

**Fiat Ducato III / Serie 8
Soundpackage 1 and 2**

Installation instructions

Status: 19.03.2024

Art. No. 69071-80-86, 69071-80-62-Q / 69081-62-Q,
69071-86-Q / 69081-86-Q, 69081-62-Miko / 69081-86-Miko
69072-80-86, 69072-80-62-Q / 69072-86-Q 69082-62-Q,
69082-86-Q / 69082-62-Miko / 69082-86-Miko

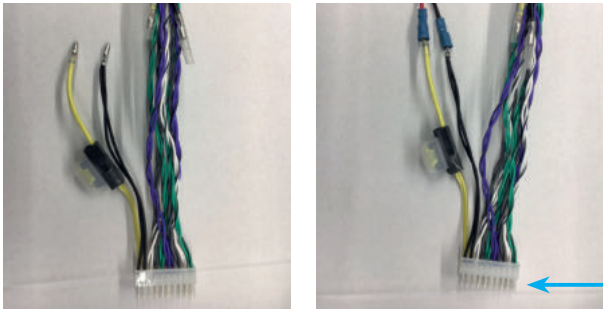

Power connection:

Disconnect the wiring harness at the plus and minus pole in the direction of the Interrupt the connection of the amplifier (see arrow).
Connect the interruption in the direction of the amplifier connection with the ground (black) and power (red) line with the original wiring harness.

Afterwards, secure the wiring harness well with adhesive tape or similar!

Amplifier connection „standard amplifier“:

1. connection to the car radio

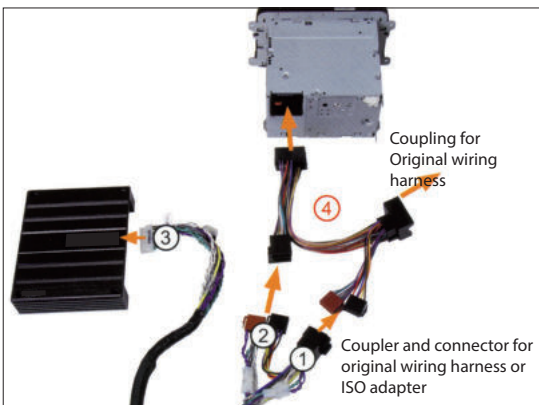

- ① ISO coupler - the wiring harness of the original radio or an ISO adapter is plugged in here.
- ② ISO plug - these are plugged into the original radio or ISO adapter.
- ③ This 20-pin connector is plugged into the amplifier.
- ④ **Optional:** ISO adapter - if the ISO plugs of the supplied wiring harness do not fit the original radio, an ISO adapter must be used.

2. connection for direct power supply from the battery.

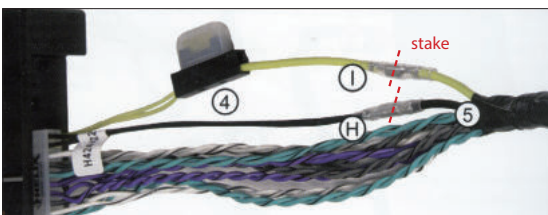

- ④ This side is connected directly to the battery. For this purpose, the cable connections I and H are disconnected.
- ⑤ After disconnecting cable connections I and H, the open ends must be insulated individually.
- I +12 volt line for connection to the positive pole of the car battery.
- H Ground line for connection to the negative pole of the car battery or for connection to the ground point of the car chassis.

Amplifier connection »High Power amplifier«:

1. connection to the car radio

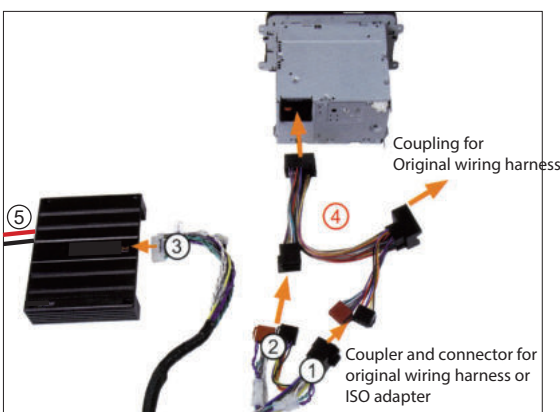

- ① ISO coupler - the wiring harness of the original radio or an ISO adapter is plugged in here.
- ② ISO plug - these are plugged into the original radio or ISO adapter.
- ③ This 20-pin connector is plugged into the amplifier.
- ④ **Optional:** ISO adapter - if the ISO plugs of the supplied wiring harness do not fit the original radio, a vehicle-specific ISO adapter must be used.
- ⑤ The power connector is connected directly to the battery using a 10mm² cable - the positive wire must be fused just before the battery (30A).



4a. Door subwoofer mounting - variant: „Standard“ (2x13s) (III)

Editing the door panel:

Mounting location: driver side door panel



4a.1 Unscrew the 4 screws at the card compartment and Remove the card compartment. The factory screws are used for mounting the subwoofer module.



4a.2 Carefully loosen the door trim clips with a plastic wedge.

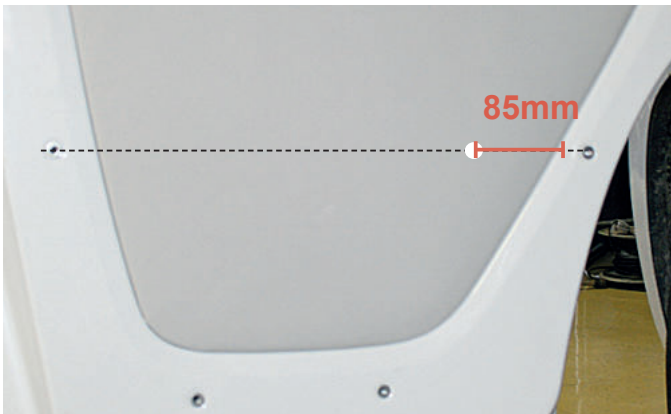

4a.3 Mark the hole for the cable gland.



4a.4 Cut the door trim cover crosswise with a cutter.



4a.5 Using a peeling drill, slowly drill out the marked hole to \varnothing 10mm. Cut a hole in the foil behind the door also cut a hole for the cable feed-through.



4a.6 In order to avoid vibration noises, prepare a screw connection to secure it. Mark the hole (see Fig.) and cut it crosswise with a cutter.

4a. Door subwoofer mounting - variant: „Standard“ (2x13s) (III)



4a.7. 3.9x16mm self-tapping screw with washer for to stabilize the door panel in the prepared hole.

4a.8. reassemble the fuse box and the cover of the armature.

+ = **black / white**
- = **black**

4.9 Connect the subwoofer.



4a.10. Mount the subwoofer module with the factory screws of the card compartment; -> fit the supplied 4 rubber rings between the rear of the subwoofer and the door trim.

4b. Door subwoofer mounting - variant: „High Power“ (1x20s) (III)

4b. First steps as for „Standard“ amplifier



4b.1. lead the subwoofer cable through the rubber sleeves into the vehicle door and behind the behind the door panel to the pre-drilled to the subwoofer behind the door trim.



4b.2. grommet for the subwoofer cable after installation seal against moisture

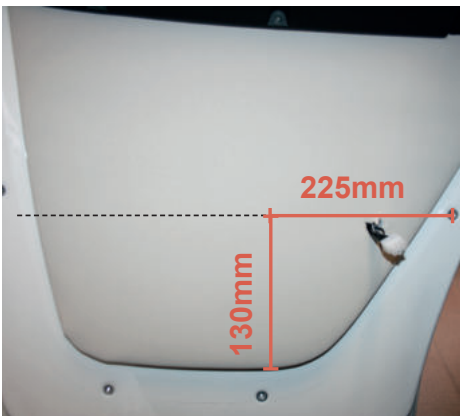

4b.2. grommet for the subwoofer cable after installation seal against moisture



4b.4. Slowly screw the 3.9x16mm collar screw with 20mm dia. washer into the prepared drill hole for stabilization.

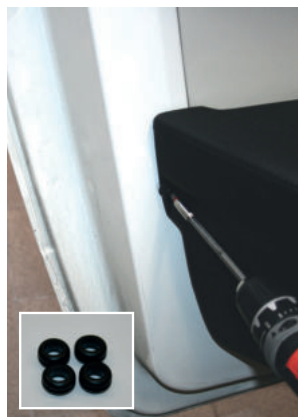

4b.5. connect the connection cable and fix the subwoofer with the screws and rubber rings supplied with the subwoofer. to the door panel using the screws and rubber rings supplied



4a. Door subwoofer mounting - from Euro 6d-TEMP - Example mounting „High Power“ (1x20s) (III)

Editing the door panel:

Mounting location: driver side door panel

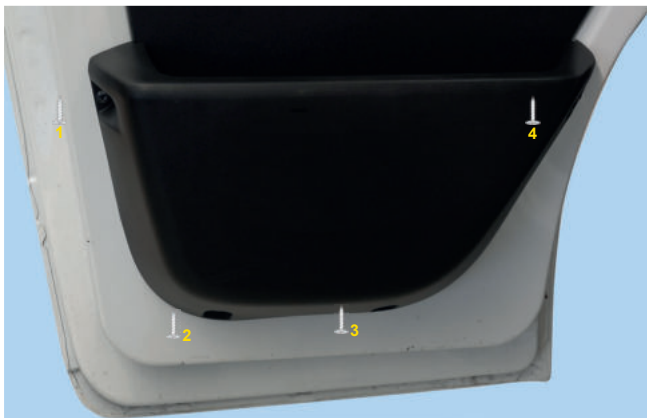

4a.1 Unscrew the 4 screws on the card compartment and remove it. The factory screws will be used for mounting the subwoofer module later.

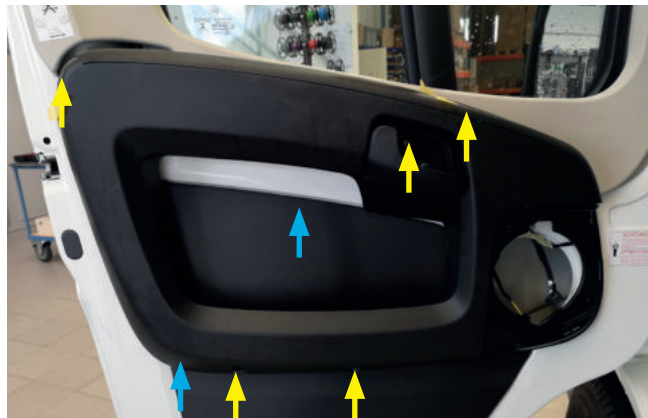

4a.2. loosen five screws (yellow arrows) of the door trim, and unclip door trim (clip positions -blue).



4a.3 To loosen the upper left screw of the door trim, first loosen the screw of the „REMIS“ blind, push it slightly upwards and remove the lower cover.



4a.4 Loosen the screws under the covers.



4a.5 Loosen the screw located under the window regulator control panel and lift off the upper part of the door panel.



4a.6 Unclip the rear part of the door trim and place it on a firm place on a firm base for processing.

4a. Door subwoofer mounting - from Euro 6d-TEMP - Example mounting „High Power“ (1x20s) (III)

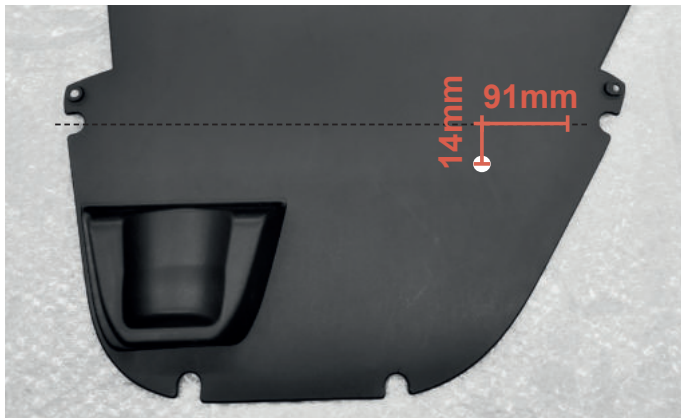

4a.7. Drill 20mm hole for cable gland:

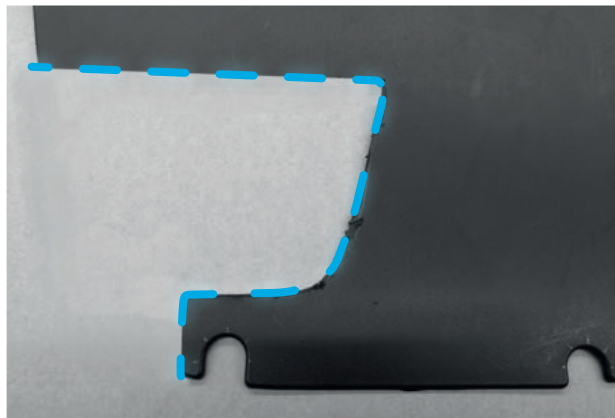

4a.8. cupholder in door panel along edge carefully saw/cut out.



4a.9 Recommendation: Insulate door trim with Alubutyl and acoustic foam mat. (Only with insulation package (optional accessory)).

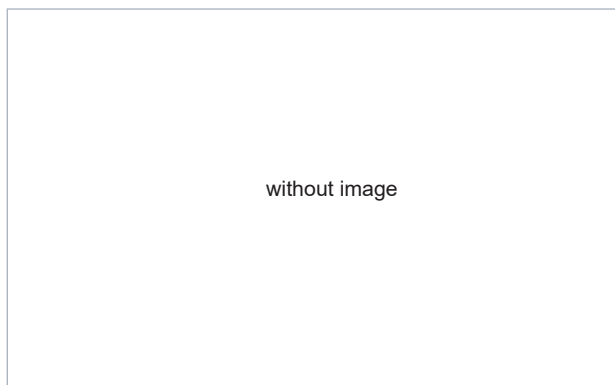

4a.10. Reassemble the fuse box and the cover of the instrumentation mount again.



4a.11. Slightly cut the foam in the area of the subwoofer cable hole slightly, feed the subwoofer cable through and tape it and seal tightly with adhesive tape.

4a. Door subwoofer mounting - from Euro 6d-TEMP - Example mounting „High Power“ (1x20s) (III)

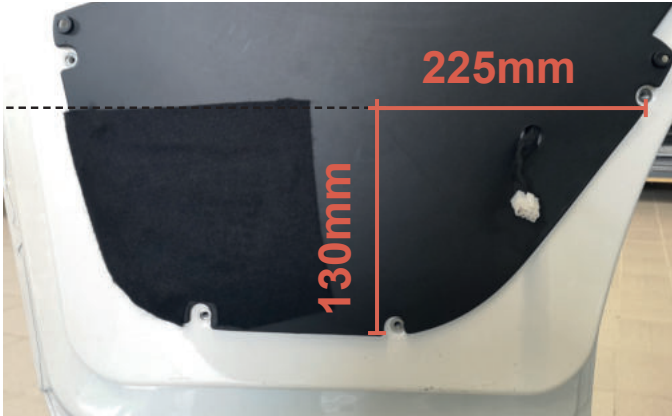

4a.12. Pull the cable through the hole, clip on the door trim again and fix in the center with self-tapping screw 4.2x16mm (see illustration).

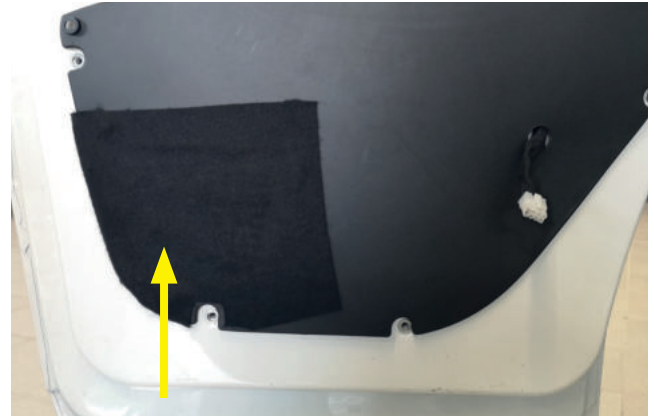

4a.13. Cupholder neckline with felt strips tape.

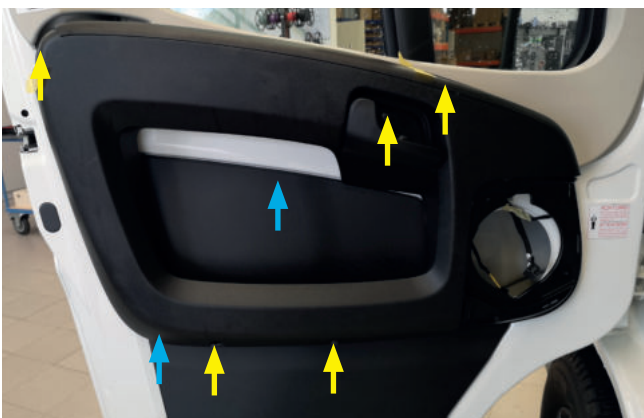

4a.14. Clip in door trim and retighten five screws (Items 2.12-2.13) of the door trim.



Tighten the upper left screw of the door trim again. Cover and screw „REMIS“ roller blind „REMIS“ roller blind screw tight again



4a.16. Tighten the screws under the power window control panel and the door opener and clip on the covers.



4a.17. Connect the subwoofer and mount it with the factory screws. mount the screws of the card compartment; place the supplied 4 rubber rings between the back of the subwoofer and the door trim.

4c. door subwoofer mounting (series 8)

Preparation

To route the subwoofer cable, the dash cover under the steering wheel must be removed as follows:



4c.1. Loosen 2 screws on the left below the steering wheel.



4c.2. Loosen 1 screw on the right underneath the steering wheel and remove cover.

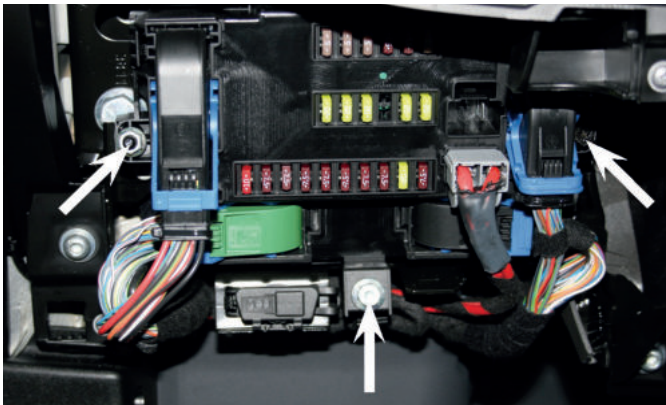

4c.3. Remove 3 screws from fuse box and pull out the fuse box.

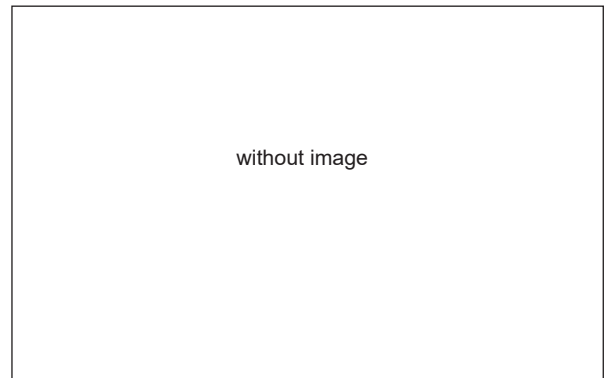

4c.4. connect the supplied subwoofer cable from the mounting place of the amplifier behind the glove compartment (passenger side) to the radio via the side pillar, behind the fuse box to the to the rubber grommet on the driver's door.

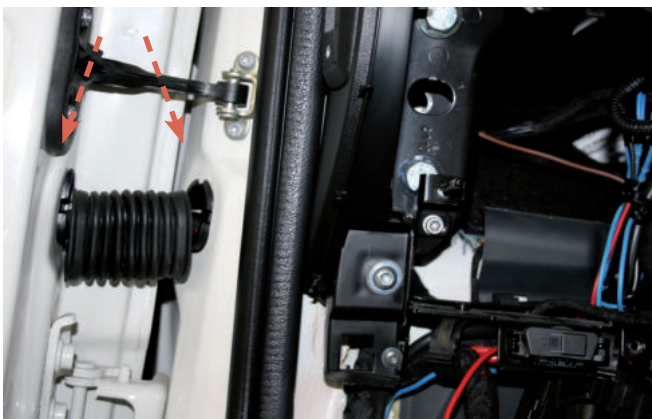

4c.5. loosen rubber sleeve on both sides.
Feel the cable grommet from the inside (quite far back and very back and very angled) and pull the subwoofer cable through (if necessary with a sturdy wire).

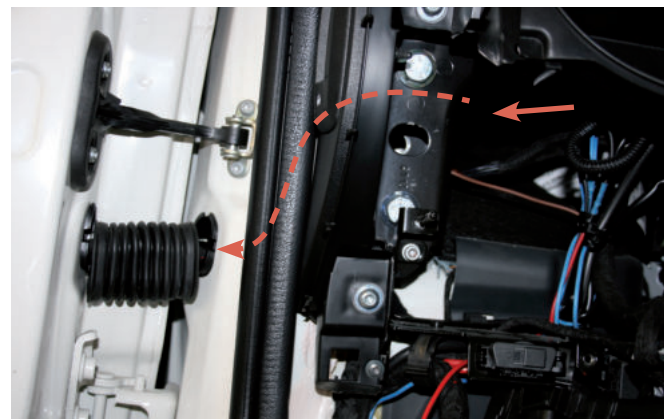

4c.6. lead the subwoofer cable through the rubber sleeve into the vehicle door and to the door panel. door and lay it behind the to the pre-drilled cable gland to the subwoofer.
To avoid vibration noises, wrap all cable strands with insulating tape or similar.

4c. Mounting the door subwoofer (Series 8)

4c.7. wiring and adjustment of the door panel



Guide the subwoofer cable through the rubber sleeves into the vehicle door and lay it behind the door trim to the pre-drilled cable gland to the subwoofer. To avoid vibration noise: Secure all cable harnesses with insulating tape or similar!

From the dismantled door panel according to the specified dimensions with a multi-cutter, cut off the side compartment. This is the position for the door subwoofer.

4c.8. mounting the door subwoofer (series 8).



Refit door panel and leave cable hanging approx. 20cm



Connect the connection cable and fix the subwoofer with the attach the subwoofer to the door panel using the factory screws and rubber rings provided

Attention when screwing down regarding leather of the subwoofer!

Connect subwoofer

6. mounting center consoles subwoofer (III and 8)

Subwoofer under cup holder center console

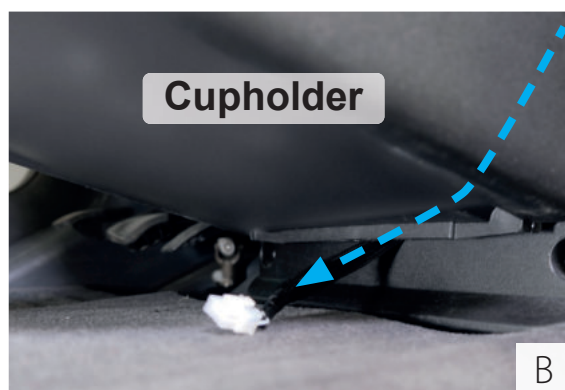
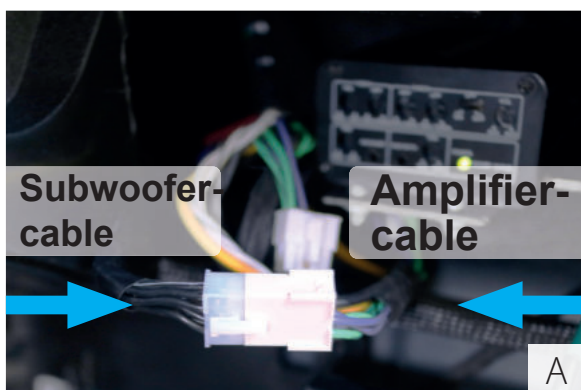

- A: Disconnect the Molex connector on the plug&play harness and connect the subwoofer cable.
B: Then lay the subwoofer cable behind the dashboard trim down to the lower edge of the cupholder trim.
C: Remove the center rubber cover between the cupholders and drill 2 holes with diameter 4mm.

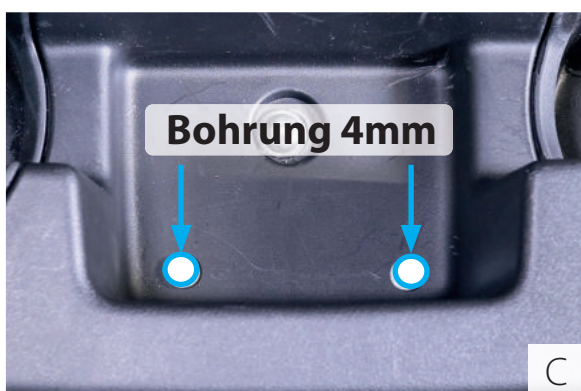

- D: Connect subwoofer cable and slide subwoofer with speaker pointing to floor under cupholder compartment.
E: Stow subwoofer cable and align subwoofer flush with cupholder trim all the way around.



- F: Finally screw the aligned subwoofer with 2 spax screws 4x45mm and replace the rubber cover cover back into place.

6. Assembly of the living room boxes

Option A: Multibox Anschluss nahe Radio

Disconnect green and purple harness (see Fig. A) and connect multi-box inputs to harness (coming from amplifier).

Purple harness: right rear speaker
unmarked cable is voltage input(+)

Green harness: left loudspeaker rear
unmarked cable is voltage input(+)

A



Option B: Multibox connection directly at the amplifier output:

Green and purple cable harness:
(see Fig. B) and connect the Multibox-
inputs.

Purple harness: right rear speaker
unmarked cable is voltage input(+)

Green harness: left loudspeaker rear
unmarked cable is voltage input(+)

B

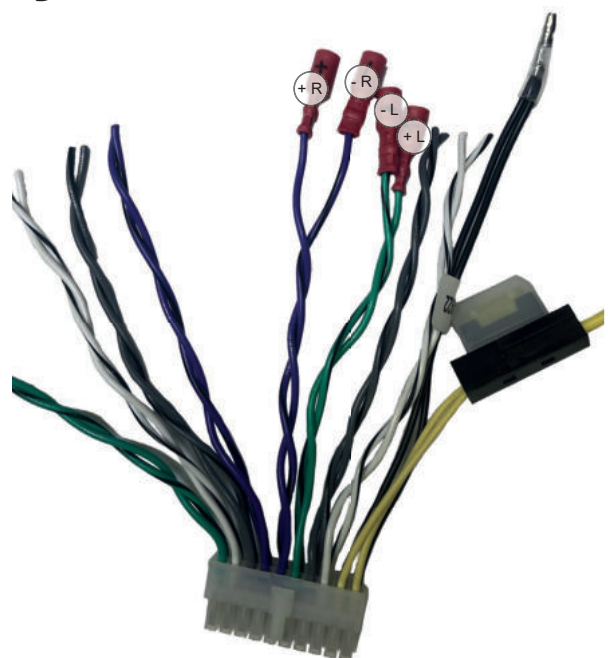

Multibox Connection information:
Multibox 5500 / 6600 / 7000 /
unmarked cable is voltage input(+)

Fiat Ducato III / Serie 8
Soundpackage 1 and 2

Installation instructions

Status: 19.03.2024

Art. No. 69071-80-86, 69071-80-62-Q / 69081-62-Q,
69071-86-Q / 69081-86-Q, 69081-62-Miko / 69081-86-Miko
69072-80-86, 69072-80-62-Q / 69072-86-Q 69082-62-Q,
69082-86-Q / 69082-62-Miko / 69082-86-Miko



Notes:

Warranty:

As the manufacturer, we warrant these sound systems for 3 years from the date of purchase from the dealer. Within this warranty period, we will, at our option, repair or replace free of charge all defects that are based on material or manufacturing defects. Excluded from the warranty are damages caused by improper use or installation, wear and tear or interventions by third parties.

The warranty does not cover consequential damage or defects that only insignificantly impair the value or usability of the sound systems.

A warranty obligation is not triggered in the case of damage caused by external influences. Systems with additional or incorrect mounting holes are excluded from exchange. These are damages to the components that cannot be repaired.

If you have any questions, please do not hesitate to contact our team in Pliezhausen:

JEHNERT SOUND DESIGN

»Development and production of car audio systems«

Inh. Hans-Peter Jehnert
Im Michelreis 14
72124 Pliezhausen
Phone: 07127-93457-0
Fax: 07127 / 93457-10
sounddesign@jehnert.de
www.jehnert.de



Share your Sound Experience
with #JehnertSoundDesign



facebook.com/jehnersounddesign



Suscribe us on Youtube

